

BEFORE MARCH 95.

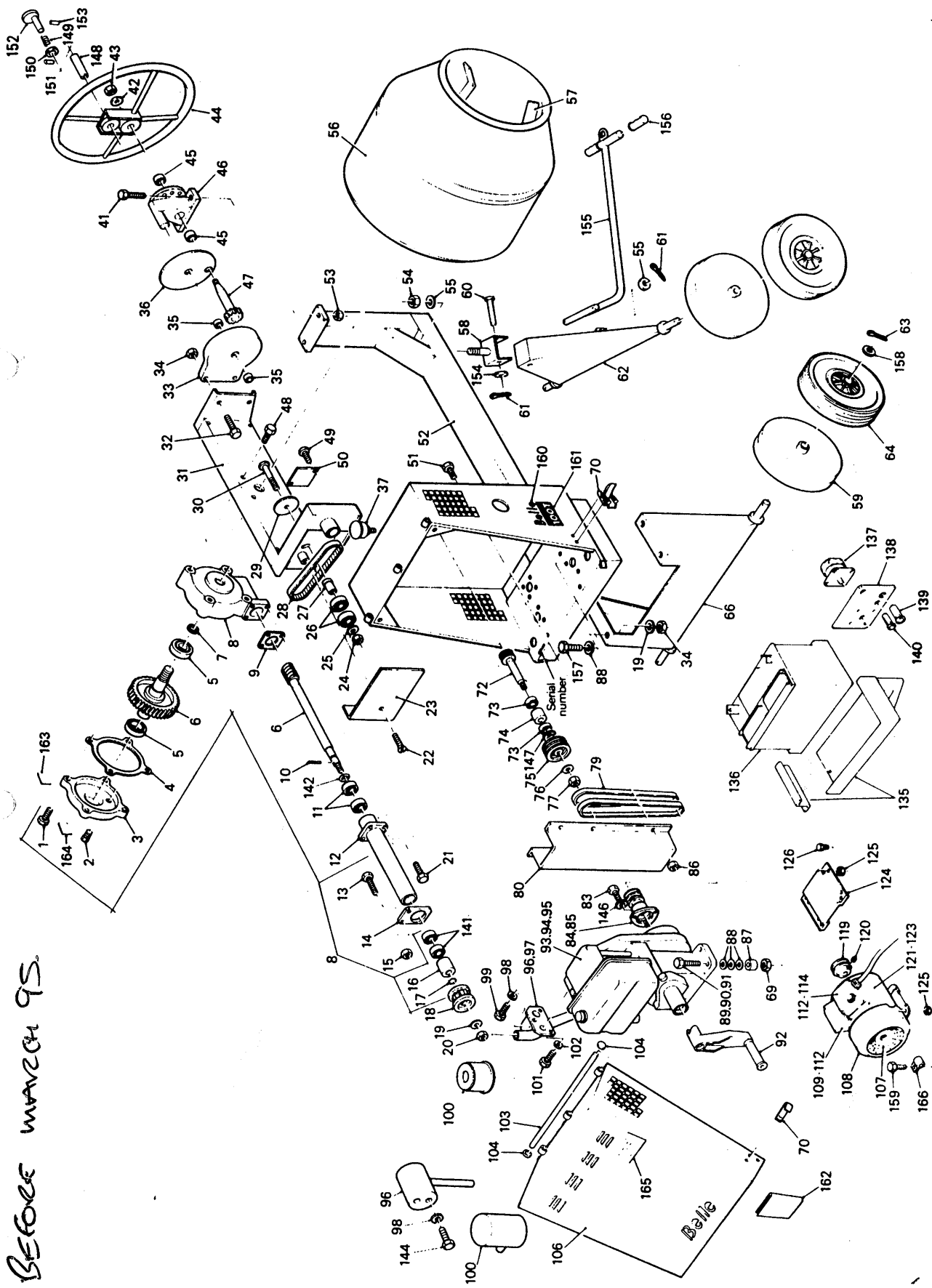

BELLE PREMIER

Belle

always quote machine serial number when ordering spares

BELLE SPARES DEPARTMENT TEL: 01298 84606

001	9/12004	BOLT - M12x50 HTS HEX BZP	074	PS021	PREMIER L/SHAFT BEARING SPACER
002	XS01	MAXI OIL FILLER BUNG	075	PS031	PREMIER LAYSHAFT PULLEY
003	PSM	CAP BEARING G/BOX 150-200T	076	4/1602	WASHER - 16 PULLEY LOCK WASHER
003A	5/0022	O RING REF RM1745-30	077	8/16002	NUT - LEFT HAND M16
003B	PS001	PREMIER BEARING CAP(I00T)	079	908/-2000	BELT V A42-1090 150T/175T/200T
004	PS110	GASKET GEARBOX CAP - NITRILE	079	PS028	BELT VEE 100T A36.5
005	PS002	PREMIER BALL RACE 8009	080	908/12100	GUARD-BELT DRIVE LISTER/ELEC
006	908/13400	SHAFT-WORM G/BOX 150T/175T/200	080	PS101	GUARD-BELT YANMAR 100T
006	908/16900	SHAFT-DRUM & WORMWHEEL A/BRNZ	083	9/12006	BOLT - M12 X 35 HT
006	PS71	PREMIER WORMSHAFT 100T	084	PS097	PREMIER LISTER PULLEY I00T/ISOT
007	PS006	PREMIER OIL SEAL - 45 x 65 x 8	085	PS040	PREMIER LTI PULLEY 175T/200TA
008	908/12400	GEARBOX 150/175/200T	085	PS103	YANMAR ENGINE PULLEY
008	PS010	PREMIER GEARBOX 100T	086	8/8002	NUT - M6 BINX BZP
008A	PS005	PREMIER GEAR CASE	087	908/11900	SPACER-ENGINE 150T/175T/200T
009	PS007	PREMIER WORMTUBE GASKET	087	PS083	PREMIER LISTER SPACER 100T
010	3/0013	PIN ROLL 4 x 22	088	4/10001	WASHER FLAT M10 BZP FORM B
011	XS31	BALL RACE 8005	089	9/12017	BOLT M12x90 HEX 8.8 BZP
012	PS012	PREMIER WORMSHAFT TUBE 100T	090	9/10008	BOLT - M10 x 60 BZP
012A	908/13500	CARR TUBE W/SHAFTISOT/175T/200	091	9/12010	BOLT - M12 X 60 BZP
012B	MS22	CIRCLIP - MINI	092	PS038	PREMIER LTI STARTING HANDLE
013/09/128	7/8008	SCREW SET M8X16mm HTS BZP	094	PS069	YANMAR MANUAL RECOIL STARTI00T
014	908/16000	PLATE SUPPORT GEARBOX	095	PS039	PREMIER LISTER LTI BUILD 10
015	8/8001	NUT - M8 BZP	095	PS084	PREMIER LISTER DIESEL ENG 32
016	PS014	PREMIER OILSEAL SPACER(W/SHT)	096	908/13600	EXH PREM WA BLD10 175T/200T
017	PS016	PREMIER OILSEAL 30 x 42 x 7	096	908/14600	MOUNTING A/C & EXH LTI W.A.
018	908/15700	PULLEY 25 TOOTH 150/175/200T	097	PS086	PREM EXH PIPE YANMAR 100T
018	PS017	TOOTHED PULLEY P24-8M 100T	098	4/8003	WASHER M8 SPRING BZP
018	PS077	TOOTHED PULLEY P22/8M B/4 MKII	100	908/14200	ELEMENT AIR FILTER LTI BLD 10
019	4/1201	WASHER M12 FORM C BZP	100	PS087	FILTER AIR - BLD 32 100T/150T
020	8/12003	NUT - M12 LEFT HAND BZP	101	9/6001	BOLT - M6 X 16 HTS/BZP
021	9/8004	BOLT - M8 X 25 HTS/BZP	102	4/6005	WASHER SPRING M6 BZP
022	7/8012	SCREW - 6 X 25 CSK SCREW BZP	103	PS067	PREMIER LID HINGE PIN
023	PS025	PREMIER DRIVE BELT GUARD	104	PS071	PREMIER HINGE PIN CAP
024	8/10003	NUT M10 HEX GRADE .8 BZP	105	PS032	PREMIER ENGINE BOX LID (MK 2)
025	4/1001	WASHER - M10 FORM C BZP	106	908/13200	COVER ENG HSG 150T/175T/200T
026	PS076	BALL RACE 8004 ZZ (BELT TENS.)	106	908/14700	COVER ENGINE 100T W.A.
027	PS081	PREMIER BELT TENSION HOUSING	107	CMS24	FAN 240/110V
028	908/12200	BELT DRIV 920 8M 25,EARLY 150T	108	CMS25	240V/110V FAN COWL
028	908/15500	BELT POLYCHAIN 150T/ 175T/200T	109	CMS17	COVER - 110V/240V CAPACITOR
028A	PS023	DRIVE BELT 720 8M 100T	110	CMS29	CAPACITOR 110V (SILVER)
029	PS024	BELT DRIVE 6/4 MK11--270L 100	110	PS098	CAPACITOR START 110VMOTOR BLUE
029	4/1203	WASHER - 12 X 30	110	PS089	CAPACITOR START 220V/240VMOTOR
030	9/10007	BOLT - M10 X 50 BZP	111	PS104	CAPACITOR RUN 220V/240V MOTOR
031	908/15300	YOKE W.A 150/175/200T	111	PS033	PREMIER NVR SWITCH 110V
031	PS018	PREMIER YOKE 100T	113	CMS34	240V NVR SWCH BOX C/W T PLATE
032/041	7/12003	SCREW - M12 X 30 HEX BZP	114	CMS36	ACC PLATE 110V
033	PS043	PREMIER RING GEAR	115	CMS60	ACC PLATE 240V CURRENT
034/063	8/12002	NUT - M12 BZP	115	908/14800	PULLEY ELEC MOTOR 150/175/200T
035	PS075	BUSH - 30 X 25 X 20 (TIP GEAR)	119	PS037	PREMIER MOTOR PULLEY
036	PS045	P-EMIER TIP GEAR COVER	120	7/6008	SCREW GRUB M6 X 8
037	PS046	PREMIER GREASE STAUFFER V8BSP	120	7/8006	SCREW - 8 X 10 GRUB SCREW
038/38/40	PS102	ASSY TIP LOCK PEG WITH SPRING	121	PS035	PREMIER ELEC MOTOR 110V (I00T)
040	PS049	PREMIER STARLOCK WASHER	121A	908/15000	MOTOR ELECTRIC 1.5KW 110VOLT
042/054	8/16003	NUT - M16 BINX	122	PS080	PREMIER MOTOR 220V
043	4/1801	WASHER - M16 FORM A BZP	122A	908/15100	MOTOR ELECTRIC 1.5KW 220VOLT
044	908/12900	HANDWHEEL PREMIER NEW STYLE	123	PS036	PREMIER ELEC MOTOR 240V (I00T)
044	PS051	***NOW USE 908/19300 ***	123A	908/13300	MOTOR ELECTRIC 1.5 KW 240v
044A	908/19300	KIT H/WHEEL UPDATE PREMIER	124	PS034	PREMIER MOTOR BASE P-ATE
045	50/000031	BUSH COMPOSITE	125	8/8002	NUT - M8 BINX BZP
046	908/12500	MOUNTING GEAR TIP	135	908/18500	MOUNTING BATTERY
046	PS050	BEARING TIP GEAR END 100T	136	PS091	PREMIER BATTERY
047	PS044	PREMIER TIP PINION AND SHAFT	137	PS092	PREMIER SWITCH
048	9/12008	BOLT - M12 X 20 BZP	138	PS093	PREMIER SWITCH BRACKET
049/061	7/6011	SCREW SET M6X10 HEX HD HTS BZP	139	PS094	PREMIER FUSE HOLDER
050	908/15900	COVERPLATE LAYSHAFT 175/200T	140	PS095	PREMIER IGNITION LIGHT
050	PS041	PREMIER -AYSHAFT COVER PLATE	141	PS013	BALL RACE 8004
052	908/10000	MAINFRAME W.A. 150T/175T/200T	142	5/0015	RING 'O' 17 VD x 1.8 THK
054	908/14400	MAINFRAME WA. 100T	146	4/1202	WASHER - 12MM SPRING BZP
055	8/20001	NUT BINX M20 BZP	147	PS022	CIRCLIP - INTERNAL
055A	4/2001	WASHER FLAT M20 BZP	148	908/15800	BUSH H/WHEEL PLUNGER
056	PS053	PREMIER DISC SPRING WASHER	149	908/10600	SPRING COMPRESSION
056	908/12600	DRUM 150T/300 WA	150	908/13100	RETAINER-SPRING
056	908/12700	DRUM 175T/350 W.A.	151	3/0012	PIN ROLL 3x24mm LG
056	908/12800	DRUM 200T/400 WA	152	908/13000	PLUNGER-HAND WHEEL
056	PS052	DRUM 100T WA	153	3/0004	PIN SPIROL 6MM H/D.
057	908/16700	BLADE & BRKT 100T	154	4/2201	WASHER FLAT M22 BZP
057	908/16701	BLADE & BRKT 150T	155	908/10400	TOWBAR W.A
057	908/16702	BLADE & BRKT 175T	158	XS35	HANDLE GRIP
057	908/16703	BLADE & BRKT 200T	157	7/12004	SCREW SET M12X25 HEX 8.8 BZP
058	908/10500	SWIVEL - FRONT AXLE NEW TYPE	158	4/0009	WASHER FLAT 84 ODx291Dx2MM
058	PS066	PREMIER STEERING SWIVEL O/TYPE	159	7/8009	SCREW SET M8X30 HEX BZP
059	PS058	PREMIER STEEL WHEEL	160	800/00200	BELLE' - WHITE
059A	PS060	PREMIER WHEEL OILITE BUSH	161	908/11000	DECAL 100T
060	908/12300	PIN AXLE SWIVEL	161	908/11100	DECAL 150T
060	PS065	PREMIER AXLE CLEVIS (4WH)	161	908/11200	DECAL 175T
061/063	3/0006	PIN SPLIT 3/16"x1/2" BZP	161	908/11300	DECAL 200T
062	908/10200	AXLEFRONT W.A NEW TYPE	162	908/15400	DECAL RUNNING INSTRUCTIONS
062	908/19200	KIT F AXLE PREM TO NEW STYLE	163	908/13600	DECAL GEARBOX LIFE
064	PS059	PREMIER RUBBER WHEEL	164	908/14100	DECAL GEARBOX OIL
064A	908/18800	WHEEL PNEUMATIC	165	900/10600	DECAL SAFETY INSTRUCTIONS
066	908/10300	AXLE REAR W.A. NEW TYPE	166	908/15200	CLIP CABLE - 240V
066	PS063	PREMIER REAR AXLE (OLD TYPE)	166	908/18200	CLIP CABLE 110v
067/133	8/12001	NUT - M12 BINX BZP	167	1/0507	PAINT SPRAY CAN ORANGE CA35
068	9/12013	BOLT - 12 X 130	167	1/0519	PAINT - LTR TIN ORANGE RAL-2004
069	8/10001	NUT M10 BINX BXP	168	1/0474	OIL SYNTHETIC 5 LITRES
070	908/10700	FASTENER & CATCH ASSY-ENG HSG	A	PS072	PREMIER MK I DRIVE SHAFT
072	908/16100	LAYSHAFT & PULLEY 150/175/200T	B	908/18600	FILTER FUEL LTI ENGINE
072	PS019	LAYSHAFT & PULLEY 100T	C	908/18700	CAP FILLER LTI ENGINE
072	PS105	LAYSHAFT/PULLEY B/4 MK2 P22-8M			
073	PS074	6005 Z LAYSHAFT BEARING			